

A.6. XVIII SECOLO

Dramma borghese e teatro musicale

2. *LO SPAZIO SCENICO*

SPAZIO SCENICO

- *scaena ductilis*
 - Jean Dubreuil
 - Inigo Jones

JEAN DUBREUIL, "SPEZZATI" (1649)

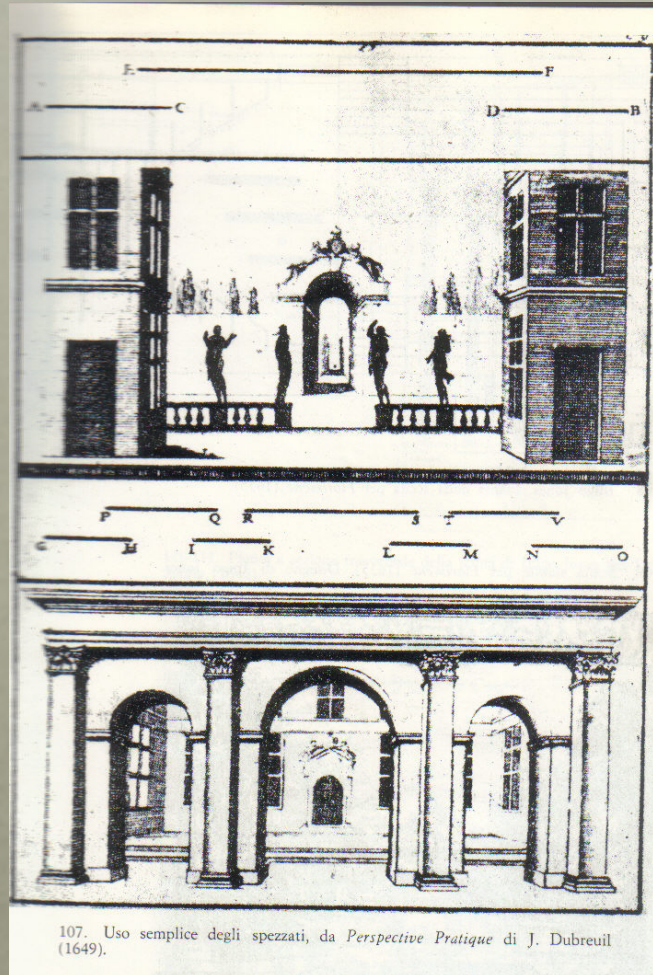

INIGO JONES, *FLORIMÈNE* (DRAMMA PASTORALE, 1635, PIANTA)

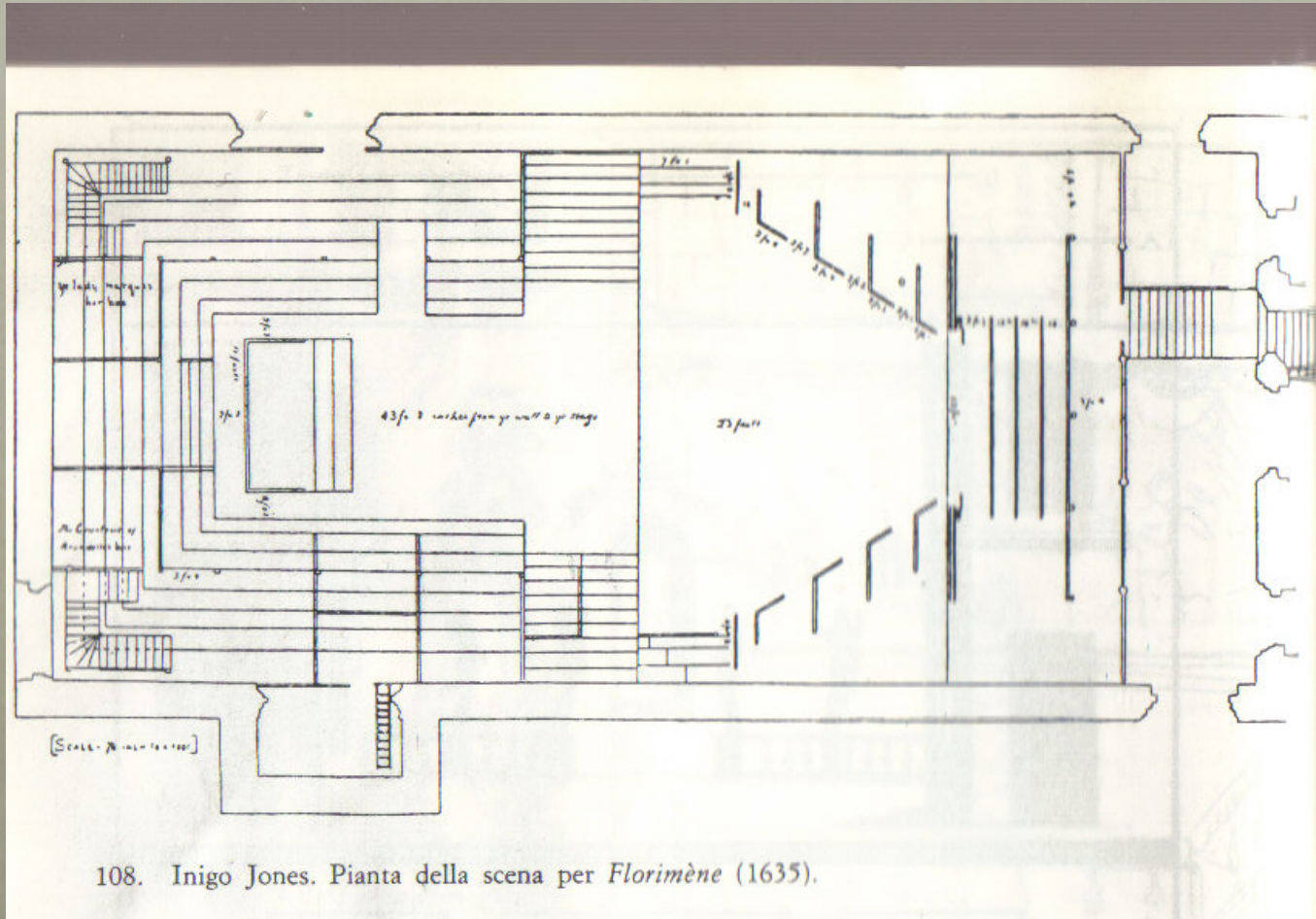

108. Inigo Jones. Pianta della scena per *Florimène* (1635).

INIGO JONES, *FLORIMÈNE* (DRAMMA PASTORALE, 1635, SCENA)

109. Scena stabile per *Florimène* (1635). Disegno di Inigo Jones.

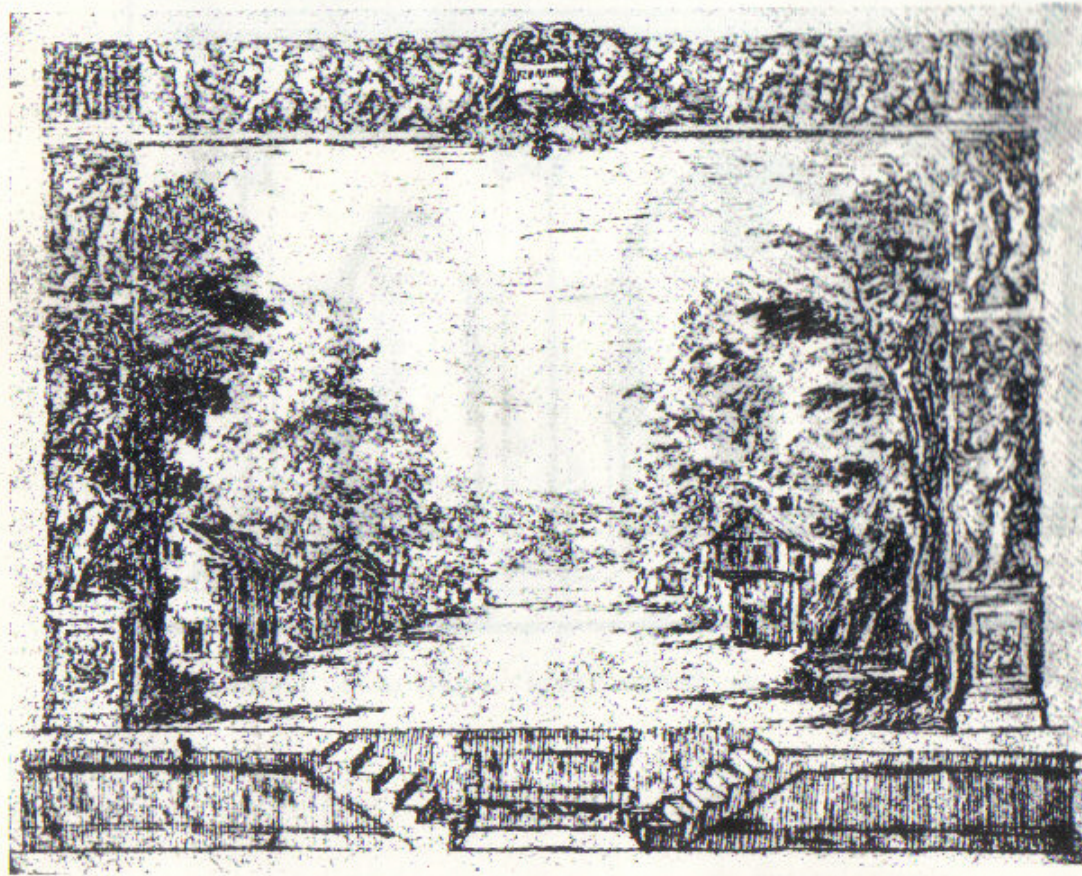

I. JONES, *SALMACIDA SPOLIA* (*MASQUE*, 1640, PIANTA E SEZIONE)

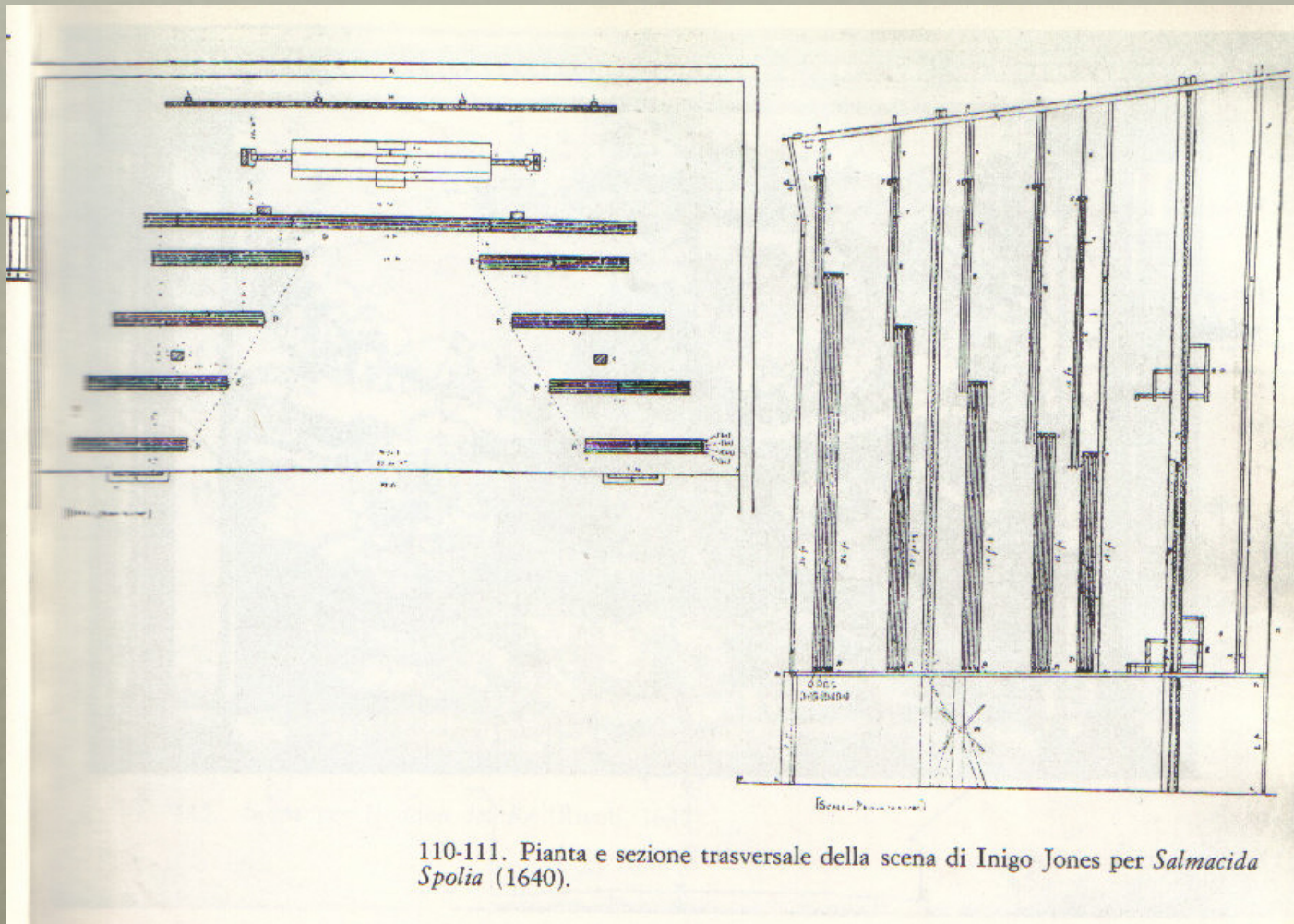

110-111. Pianta e sezione trasversale della scena di Inigo Jones per *Salmacida Spolia* (1640).

I. JONES, *SALMACIDA SPOLIA* (*MASQUE*, 1640, SCENA)

112. Bozzetto di Inigo Jones per la terza scena di *Salmacida Spolia* (1640).

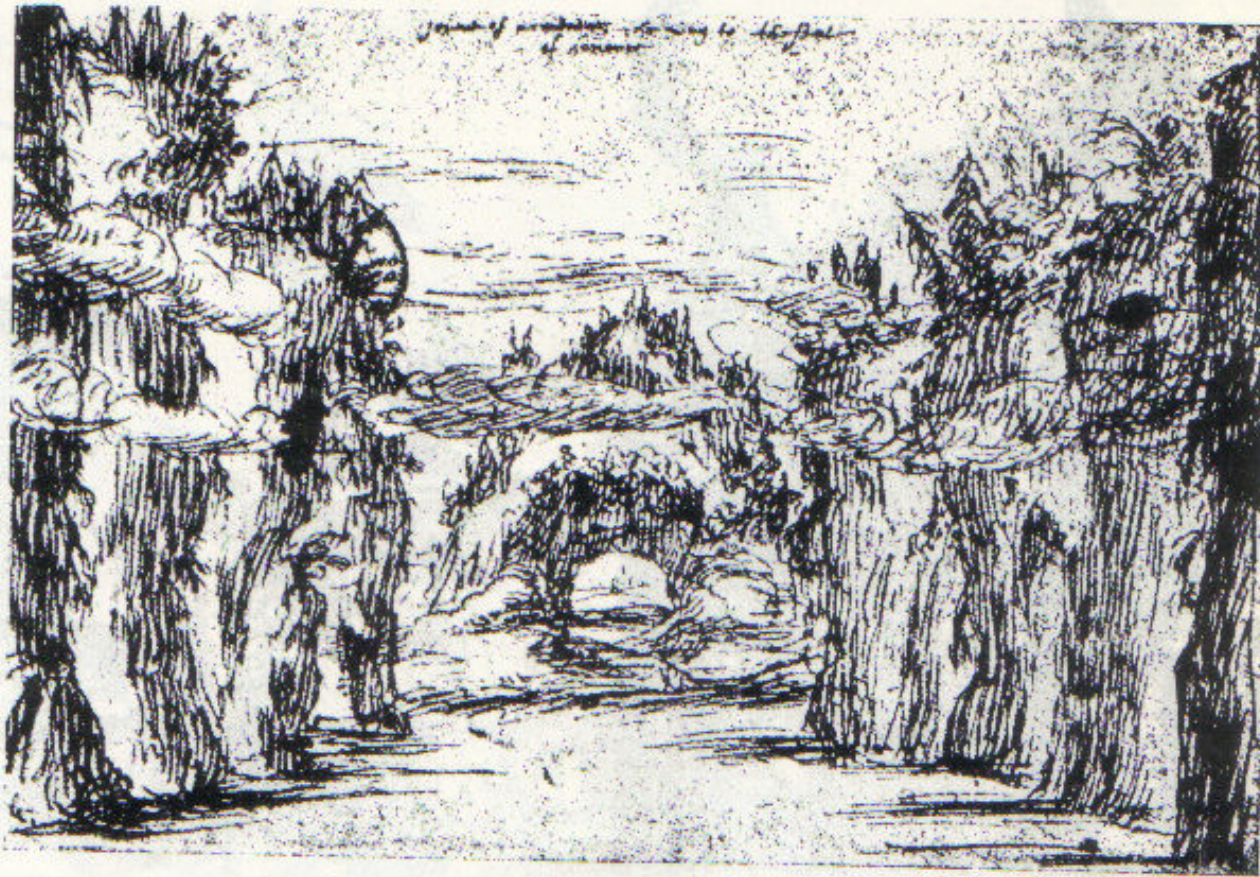

FIRENZE, TEATRO LA PERGOLA (ARCH. FERDINANDO TACCA, 1656)

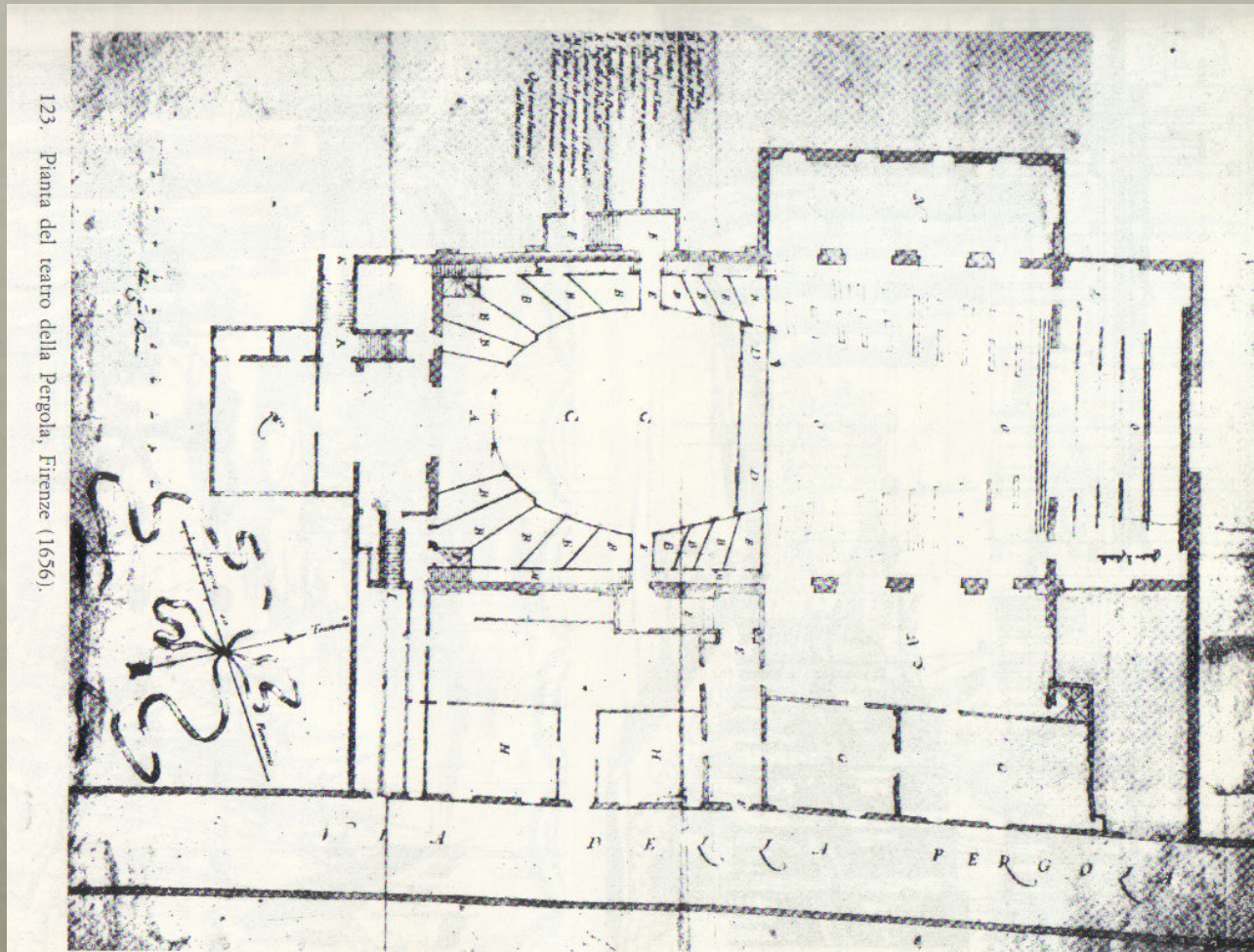

GIACOMO TORELLI (1608-78)
BOZZETTO PER *BELLEROFONTE* (VENEZIA, 1643)

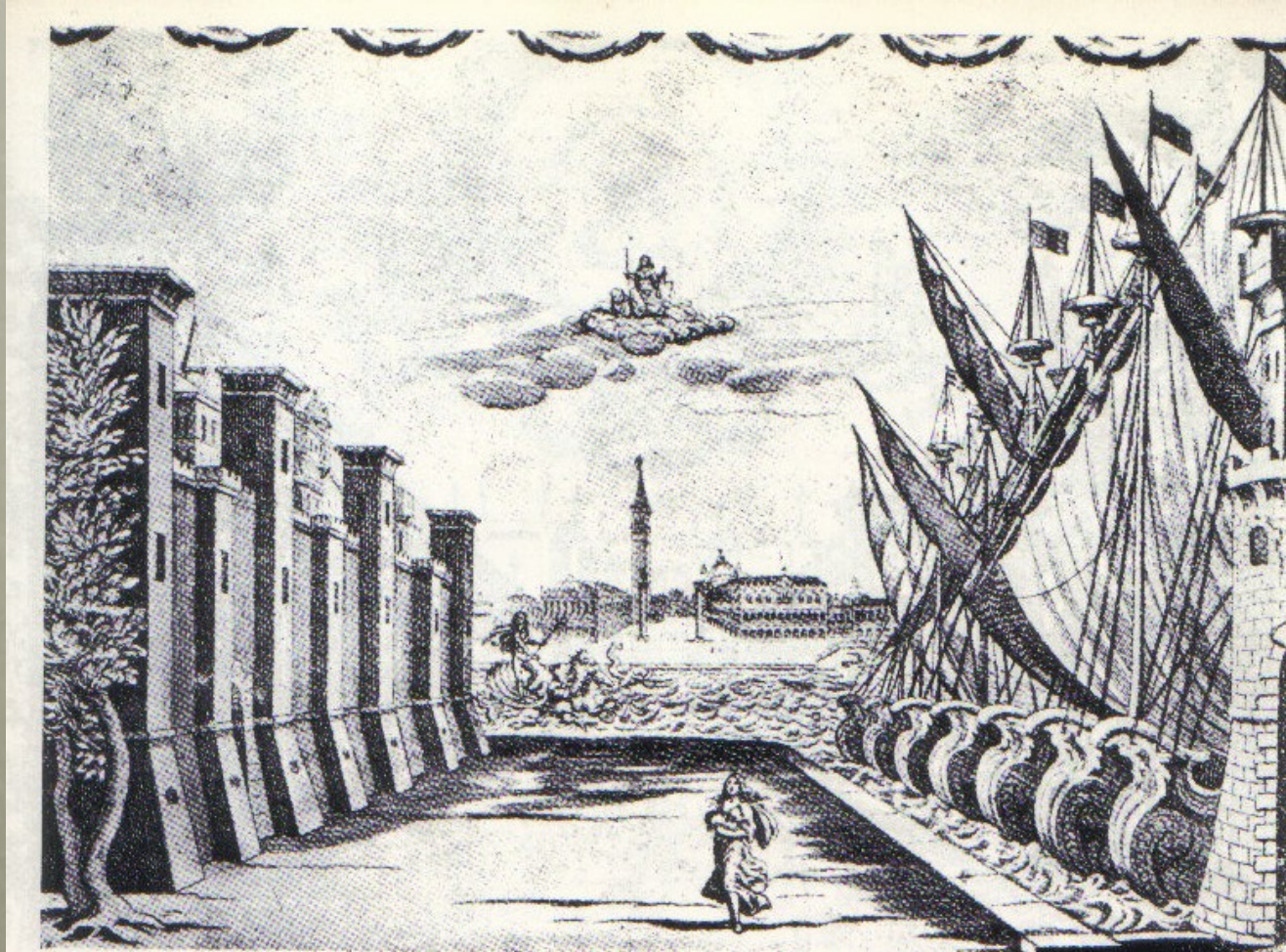

GIACOMO TORELLI (1608-78)
BOZZETTO PER *VENERE GELOSA* (1643)

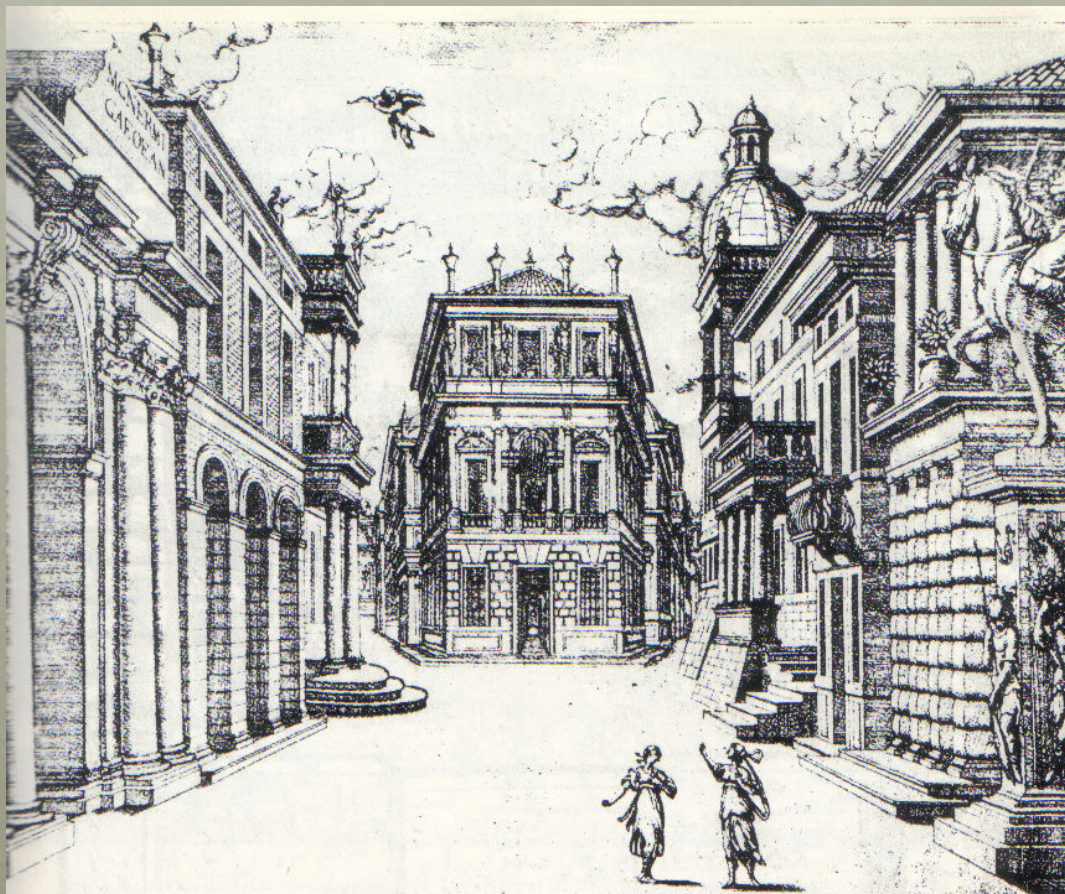

132. Bozzetto di Giacomo Torelli per *Venere Gelosa* (Venezia, 1643).

LA FAMIGLIA BIBIENA

- Giovanni Maria (1619-1665), padre di
- Ferdinando (1657-1743) e Francesco (1659-1739)
- Alessandro (1687-1769), nipote
- Giuseppe (1696-1756), nipote
- Antonio (1700-1774), nipote
- Giovanni (m. 1760), nipote
- Carlo (1725), pronipote

GIOVANNI BIBIENA

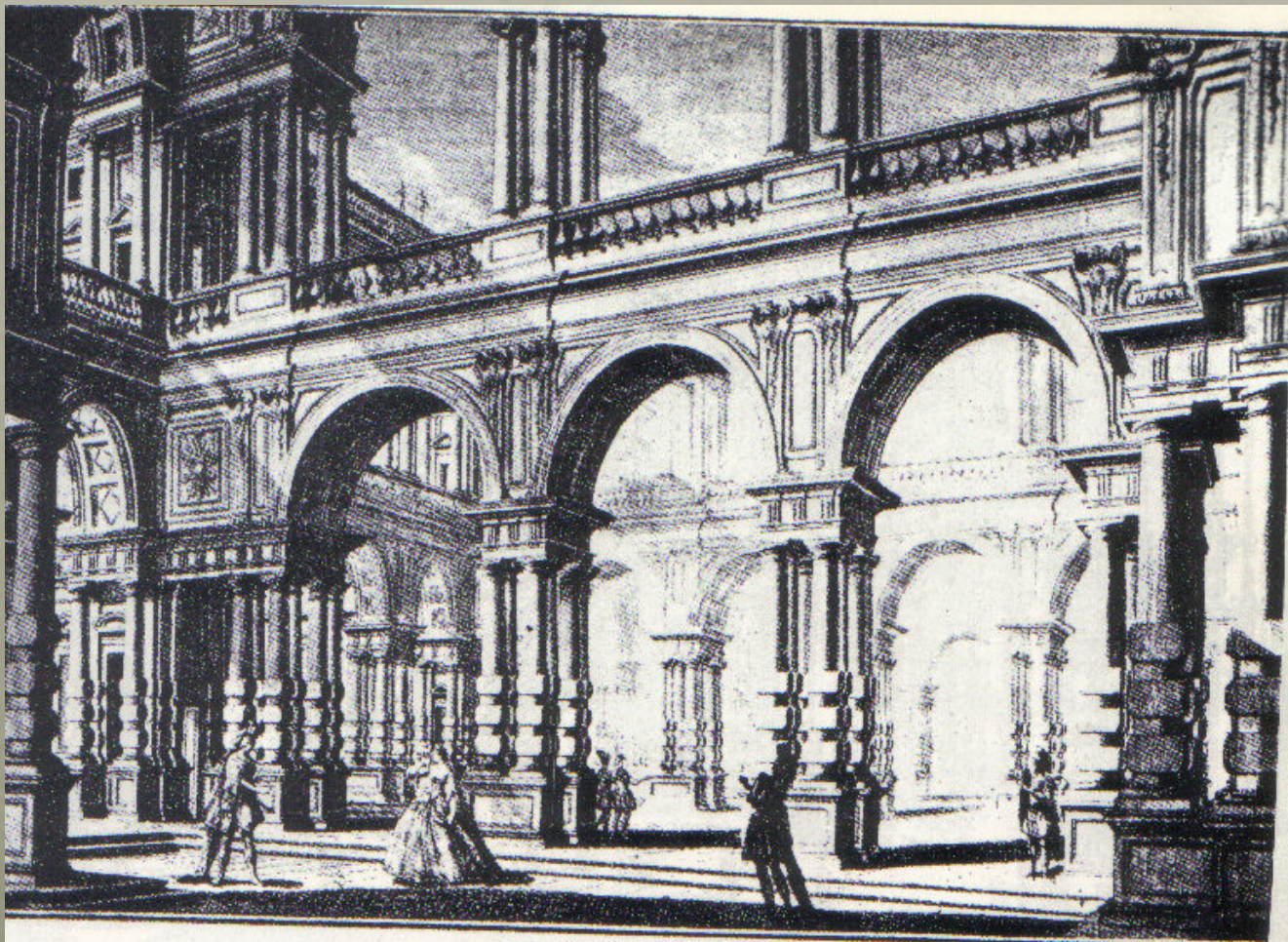

VENEZIA, SAN ZANIPOLO (1638-39)

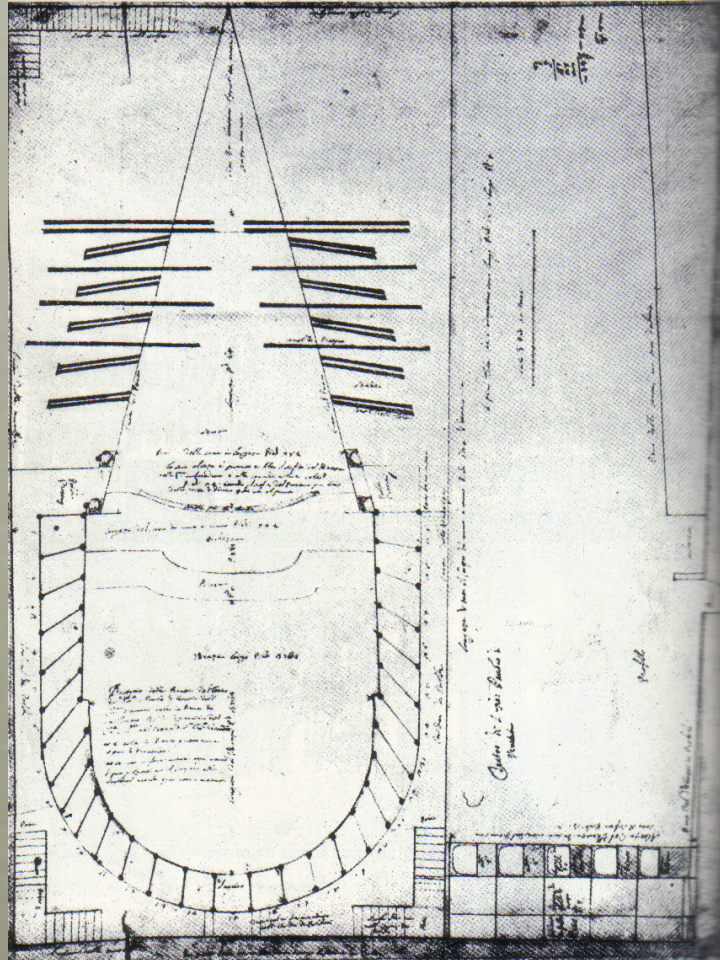

SIENA, TEATRO DEGLI INTRONATI (1670)

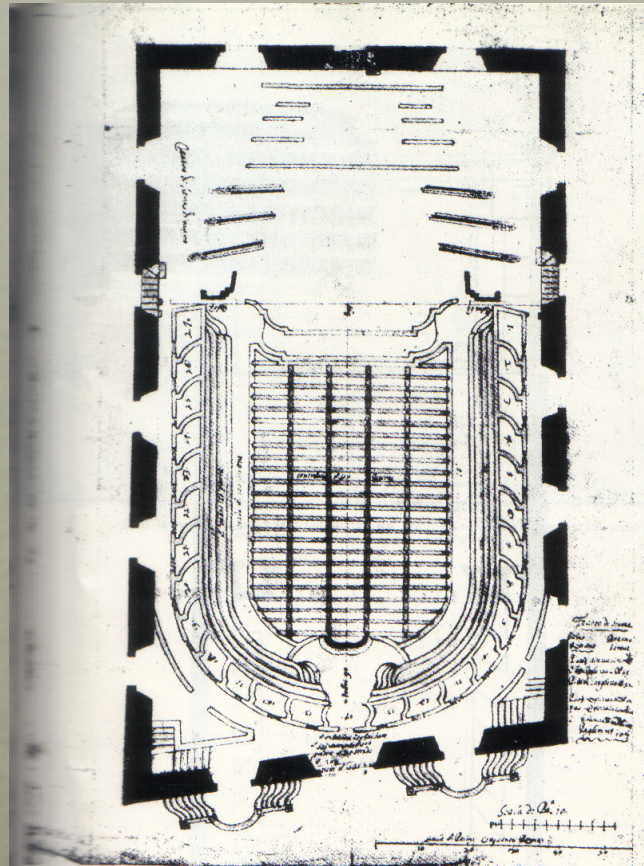

ROMA, TEATRO TOR DI NONA (CARLO FONTANA, 1660)

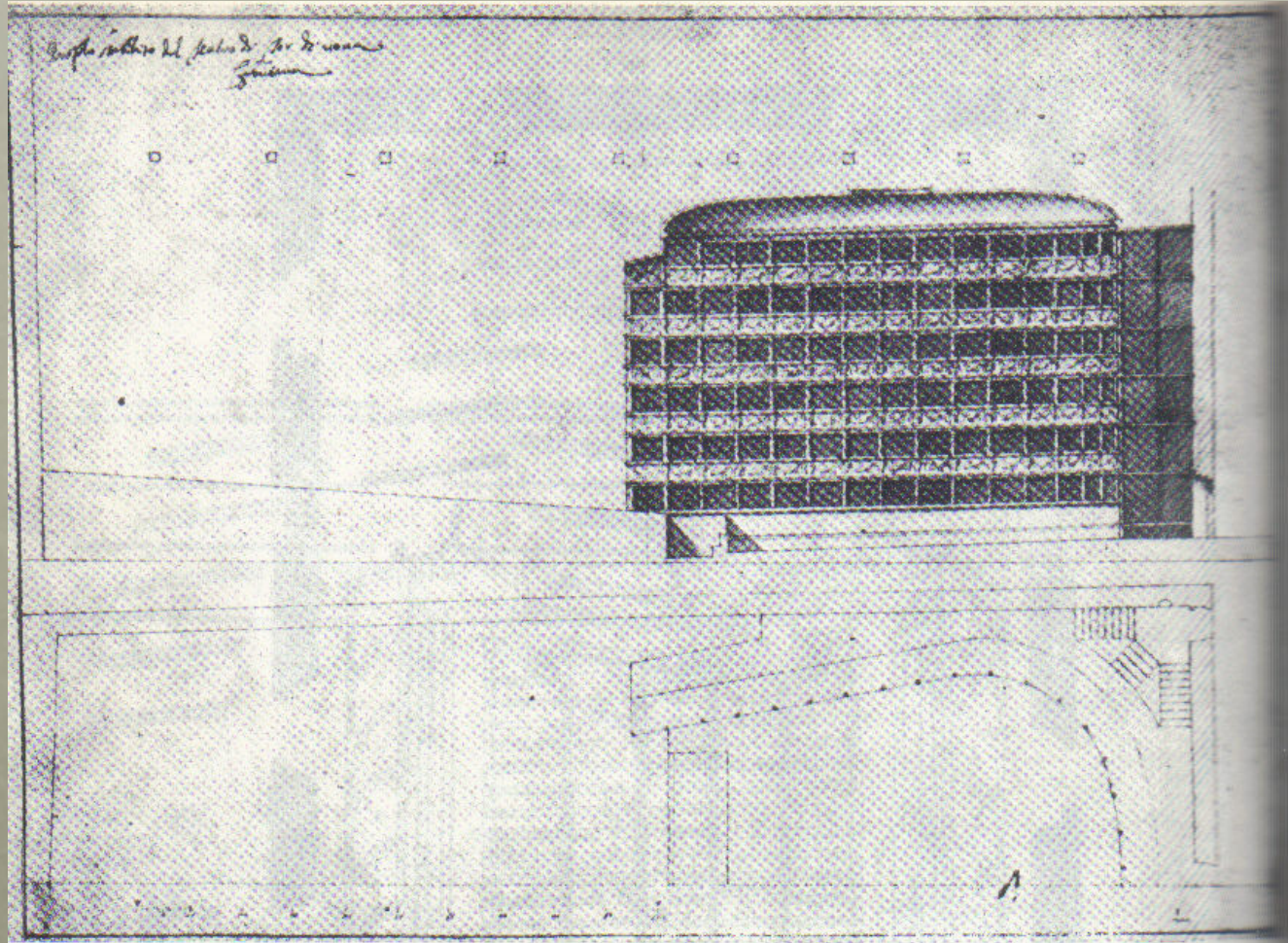

FANO, TEATRO DELLA FORTUNA (TORELLI, 1677)

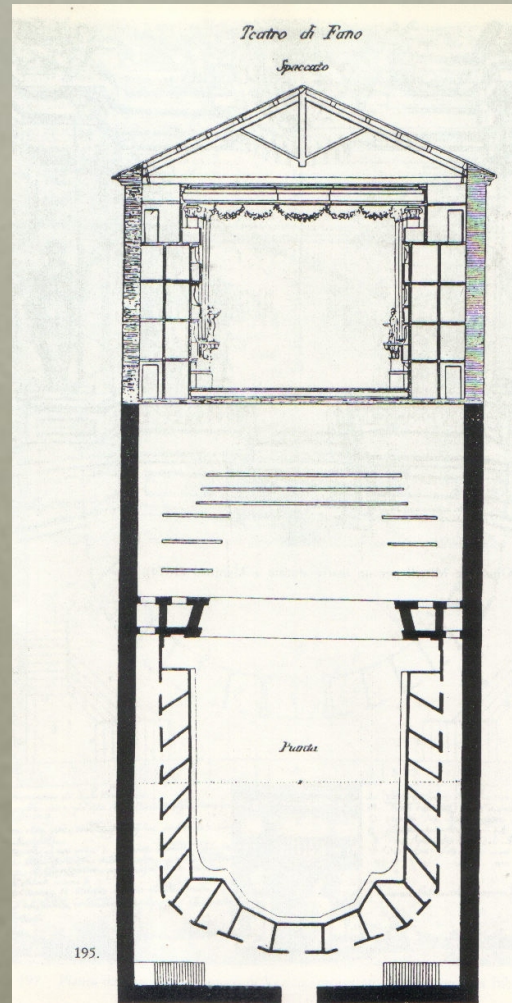

TEATRO ARGENTINA, ROMA TEATRO SAN CARLO, NAPOLI

Teatro Argentina
Roma, 1732

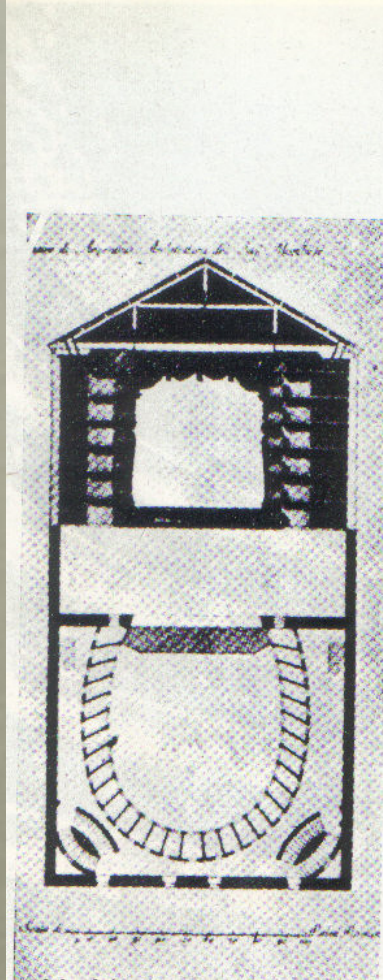

Teatro San Carlo
Napoli, 1737

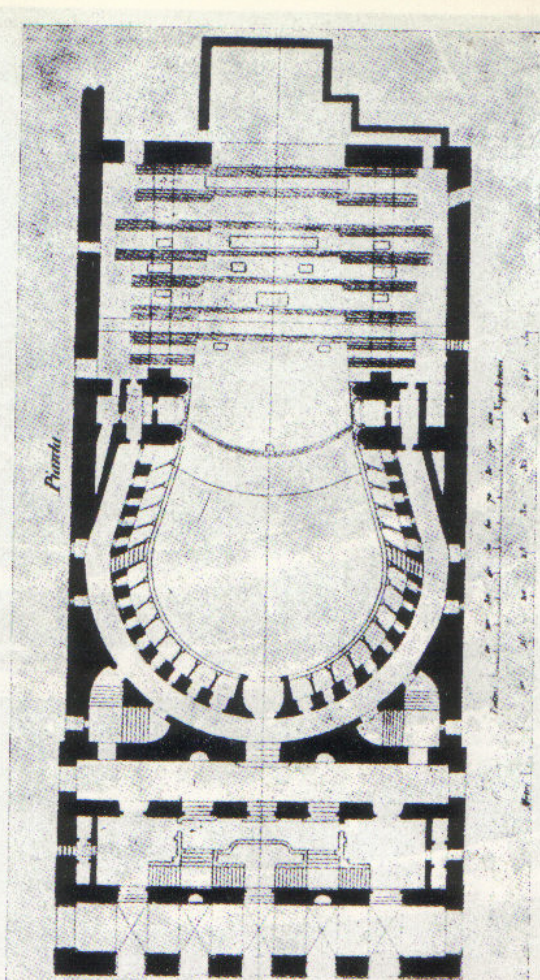

TORINO, TEATRO REGIO (1738)

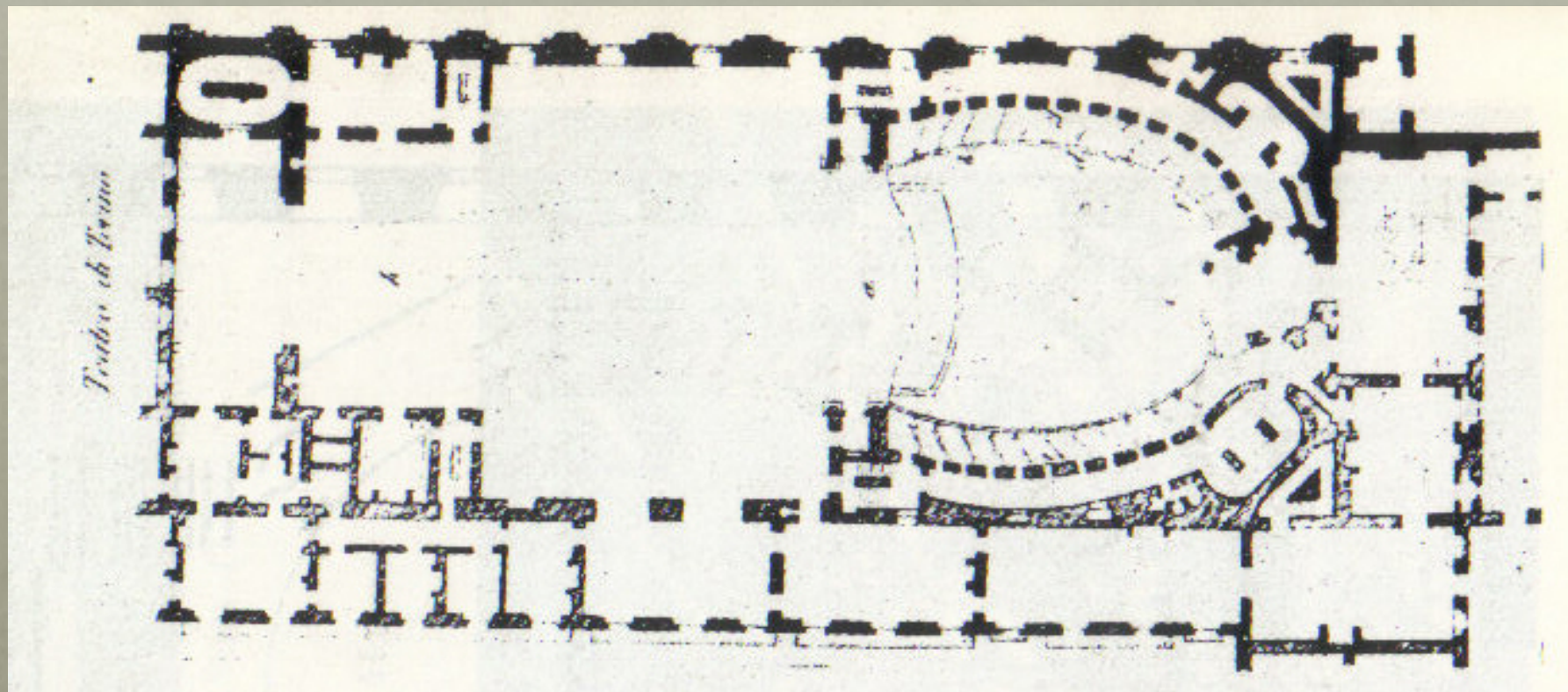

MILANO, LA SCALA (1778)

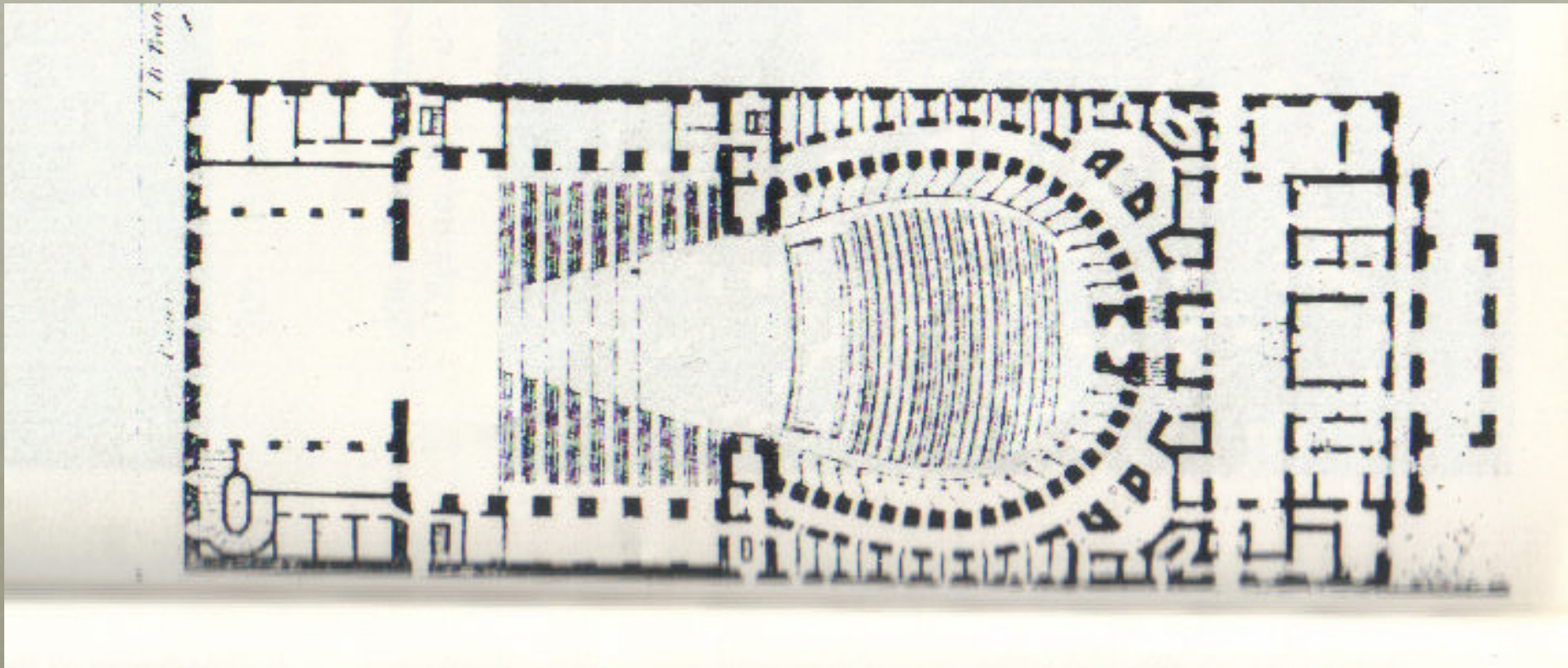

VENEZIA, LA FENICE (1792)

